

General notes:
 All materials and construction methods to comply with the fully aware of the contents of this drawing, that it is the right of ownership on this drawing and shall for the purpose of this drawing and shall not be used for any other purpose without the written consent of the architect.
 Copyright ART 21(1)98/1978

I/we, the undersigned, hereby confirm that I/we are fully aware of the contents of this drawing, that it is the right of ownership on this drawing and shall for the purpose of this drawing and shall not be used for any other purpose without the written consent of the architect.
 Architect: _____ Date: _____
 Engineer: _____ Date: _____
 Other: _____ Date: _____

Project:
New proposed office development on stands 3317 Irene ext. 72

Description:
first floor plan roof plan

Drawing No:
1236-102
 Date:
 October 2013
 Drawn:
 JH
 Checked:
 AS
 Scale:
 1:100
 Revision:
 3

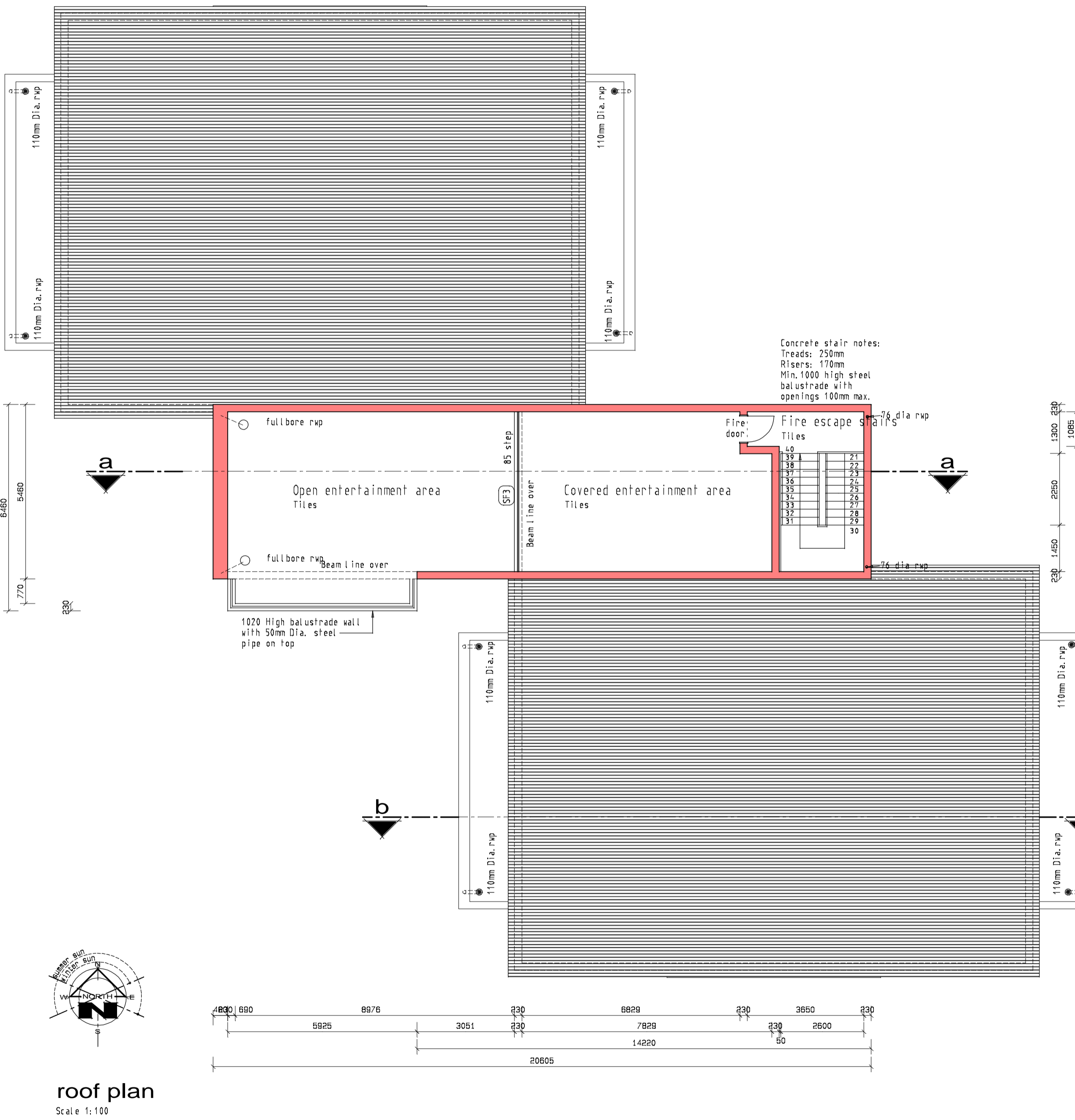
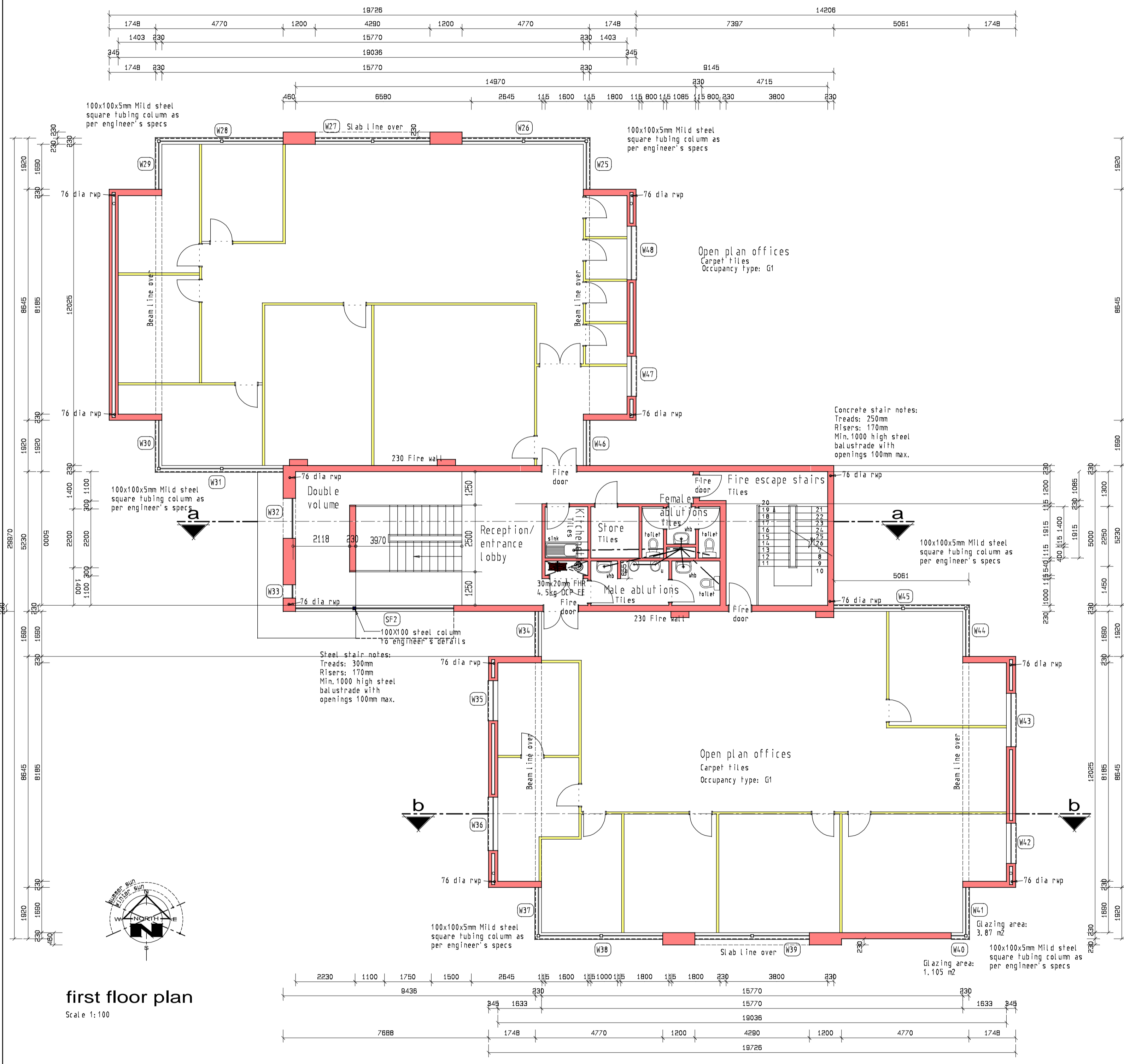

Concrete stair notes:
 Treads: 250mm
 Risers: 170mm
 Min. 1000 high steel balustrade with openings 100mm max.

Concrete stair notes:
 Treads: 250mm
 Risers: 170mm
 Min. 1000 high steel balustrade with openings 100mm max.

Steel stair notes:
 Treads: 300mm
 Risers: 170mm
 Min. 1000 high steel balustrade with openings 100mm max.

Glazing area:
 3.87 m²
 1.105 m²